

## PTFE sinter filter with screw threaded M11

### Description

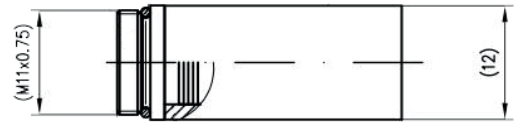

### Technical data

PTFE sintered filter	
Material	PTFE
Pore size	15 µm
Features	Hydrophobic, water resistant
Temperature range	-50...+145 °C
Dimensions	Ø 12 x 32 mm
Inner diameter	9 mm
Screw threaded	M11 x 0,75 with sealing
Art.-No.	0400 0449-50

### Description

Humidity sensors in continuous duty are prone to dust deposits and contamination. With the help of this high quality sinter filters, the sensor element can be protected against external effects. The filters are also suitable for other gas sensors.

The sinter filter of PTFE with 15 µm pore size are of very fine grain size and are also short time resistant against water jets (hydrophobic).